

EMERGENCY DOWNLIGHT

EM DL60

Single LED Emergency Downlight



Technical specifications

| | |
|------------------------------------|--------------------------------------------------------|
| Mains voltage range | 220 – 240 V |
| Mains frequency | 50 / 60 Hz |
| Power consumption | max. 2,4 W / 3 VA |
| Switchover time mains to emergency | < 0,5 s |
| Max. housing temperature t_c | 65 °C |
| Ambient temperature range t_a | 5 – 50 °C |
| Functionality test | weekly 2 min. (random – see data sheet self-test) |
| Duration test | annually |
| Battery charging time | 24 h |
| Protection classes | I and II |
| Protection type | IP20 |
| Weight | 140 g + battery (45 g for 1 cell, 90 g for 2 cells) |
| Dimensions of power module | L 205 x B 37 x H 21,75 mm |
| LED lamphead diameter | 48 mm |
| LED colour temperature | 5300 – 6000 K |

Y housing

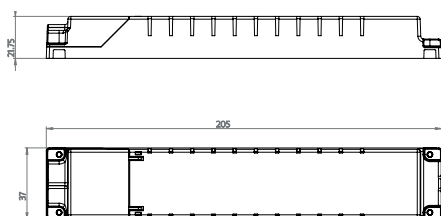

Product description

The EM DL60 emergency downlight consists of an LED lamphead with integrated LFP battery, status display LED and an emergency lighting unit to operate the single LED in maintained or non-maintained mode. The safety-compliant emergency downlight is designed for recessed ceiling mounting and ensures emergency escape route and open area lighting in buildings. The integrated self-test function complies with the latest European standards.

- Self-contained emergency downlight
- Single LED lamphead with integrated LiFePO₄ battery, status display LED and connected emergency lighting driver
- High-quality aluminium PCB (powder-coated)
- Polycarbonate case for protection classes I and II (L 205 x W 37 x H 21,75 mm)
- 60 months warranty

Properties

- Non-maintained and maintained mode
- Night light option (R - reverse dimmed maintained mode)
- Bus communication options available
- Different lenses for LED protection for emergency escape route lighting (elliptical) and open area lighting (rotationally symmetric)
- Straightforward recessed mounting of preinstalled luminaire and driver with strain relief
- 1 h, 3 h or 8 h emergency mode operating time
- Self-test function as per IEC 62034
- Bi-colour LED status display
- SELV (safety extra low voltage)
- Constant power output in emergency mode
- Adapted charging cycle for LFP batteries
- Deep discharge protection

The maximum LED current in maintained mode, i.e. in active operation should not exceed 2,5 A.

Dimensional drawings Single LED

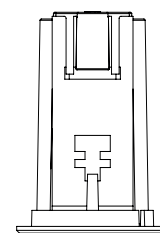
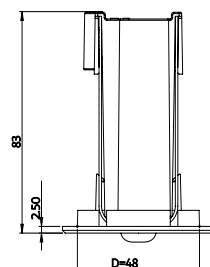
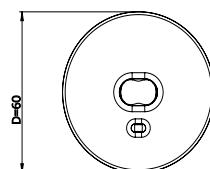

Technical specification

| specification \ device type | EM DL60-S | | EM DL60-SR | |
|------------------------------------------------|-------------------------------------------------------------|---------------------------------------|-------------------------------------------------------------|---------------------------------------|
| lens types | elliptical (corridor) rotationally symmetric (open area) | | elliptical (corridor) rotationally symmetric (open area) | |
| operation mode | non-maintained | | maintained or non-maintained | |
| night light option (R) | - | | <input checked="" type="checkbox"/> | |
| luminous flux in night light option (R) | - | | 50 lm | |
| mains output power | - | | 0,3 - 2 W | |
| mains luminous flux | - | | 40-260 lm | |
| DALI communication option | - | | <input checked="" type="checkbox"/> | |
| emergency operation duration | 1 h / 3 h / 8 h | | 1 h / 3 h / 8 h | |
| battery types LiFePO4 | 3.2V/1x1865/1.5Ah | 3.2V/2x1865/3Ah | 3.2V/1x1865/1.5Ah | 3.2V/2x1865/3Ah |
| emergency operation luminous flux | 1h: 150 lm 3 h: 75 lm 8 h: 20 lm | 1h: 300 lm 3h: 150 lm 8h: 40 lm | 1h: 150 lm 3 h: 75 lm 8 h: 20 lm | 1h: 300 lm 3h: 150 lm 8h: 40 lm |
| luminaire spacing for escape routes | 40 lm = 3.5 m 75 lm = 6 m 150 lm = 12 m | | | |
| SELV | <input checked="" type="checkbox"/> | <input checked="" type="checkbox"/> | <input checked="" type="checkbox"/> | <input checked="" type="checkbox"/> |
| battery regeneration | <input checked="" type="checkbox"/> | <input checked="" type="checkbox"/> | <input checked="" type="checkbox"/> | <input checked="" type="checkbox"/> |

Selftest

- Selftest as per IEC 62034
- Bi-colour LED status display
- Battery status
- LED module status
- Charging cycle

Batteries

- High-temperature cells 5 to 50 °C
- LFP batteries
- 18650 cells
- Specific capacities depending on emergency operation duration
- Charging time 24 h
- Battery regeneration for capacity optimisation
- See battery data sheets for details

Certification mark

- CE



Photometric data

Available in LDT format upon request.

Safety

- Protection classes I and II
- Protection type IP20
- Lens for power LED protection
- Double insulation between mains and LED output
- SELV

Standards

- EN 60598-2-22
- EN 61347-2-7
- EN 61347-2-13
- EN 62384
- EN 62034
- EN 55015
- EN 61000-3-2
- EN 61000-3-3
- EN 61547
- Suitable for systems conforming to: VDE 0108 or EN 50172

Mounting

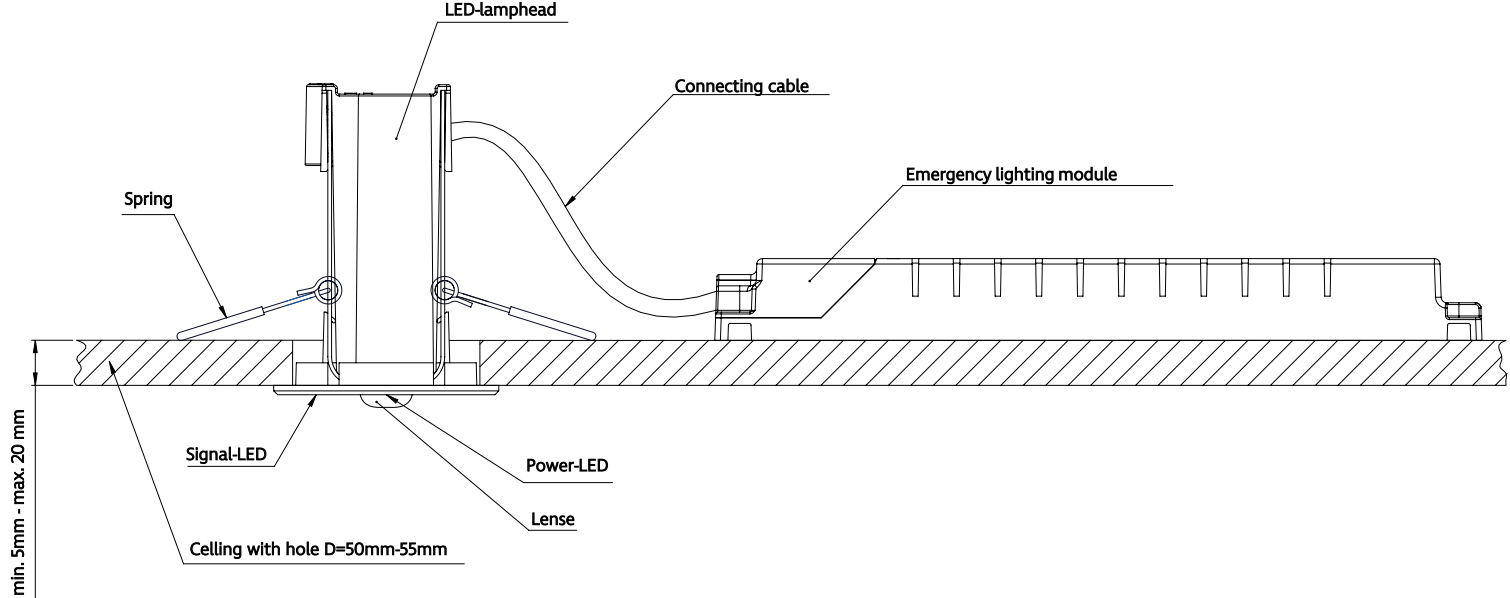

All information is supplied without liability. Technical data subject to change without notice.